

The MAXX™ Press DIGITAL CLAM OPERATOR'S MANUAL



16"x20"

11"x15"

15"x15"



a GroupeSTAHL company

Safety Instructions

When using your heat press,
basic precautions should always be followed,
including the following:

1. Read all instructions.
2. Use heat press only for its intended use.
3. To reduce the risk of electric shock, do not immerse the heat press in water or other liquids.
4. Never pull cord to disconnect from outlet, instead grasp plug and pull to disconnect.
5. Do not allow cord to touch hot surfaces, allow heat press to cool completely before storing.
6. Do not operate heat press with a damaged cord, or if the equipment has been dropped or damaged. To reduce the risk of electric shock, do not disassemble or attempt to repair the heat press, take it to a qualified service person for examination and repair. Incorrect reassembly or repair could cause a risk of fire, electric shock, or injury to persons when the equipment is used.
7. Close supervision is necessary for any heat press being used by or near children. Do not leave equipment unattended while connected.
8. Burns can occur when touching hot metal parts.
9. To reduce the likelihood of circuit overload, do not operate other high voltage equipment on the same circuit.
10. If an extension cord is necessary, then a 20 amperage rated cord should be used. Cords rated for less amperage may overheat, care should be taken to arrange the cord so that it cannot be pulled or tripped over.

SAVE THESE INSTRUCTIONS

Safety Instructions	2
Machine View	4
Control Panel Guide	5
Operating Instructions	6-11
Connecting the System	6
Turning the System On	7
Adjusting the Temperature	8
Adjusting the Time	9
Adjusting the Pressure	10
Pressing	11
Replacement Parts List	12
Parts Location Guide	13
Electrical Schematic	14
Contact	15

FRONT VIEW

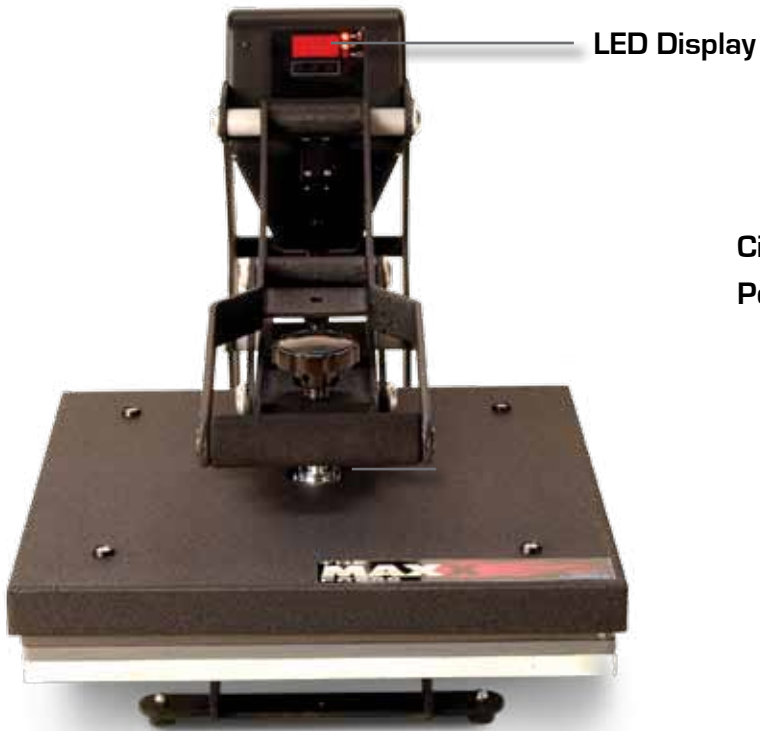

Located in the Back
of the Press

Circuit Breaker
Power Supply

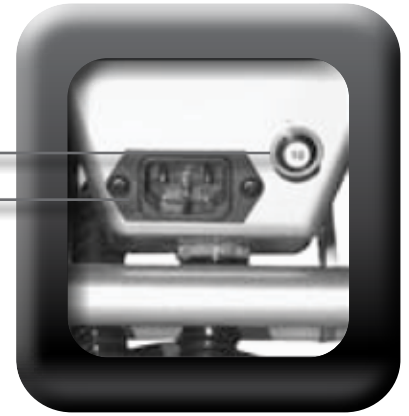

SIDE VIEW



The MAXXY™ Press Control Panel Guide

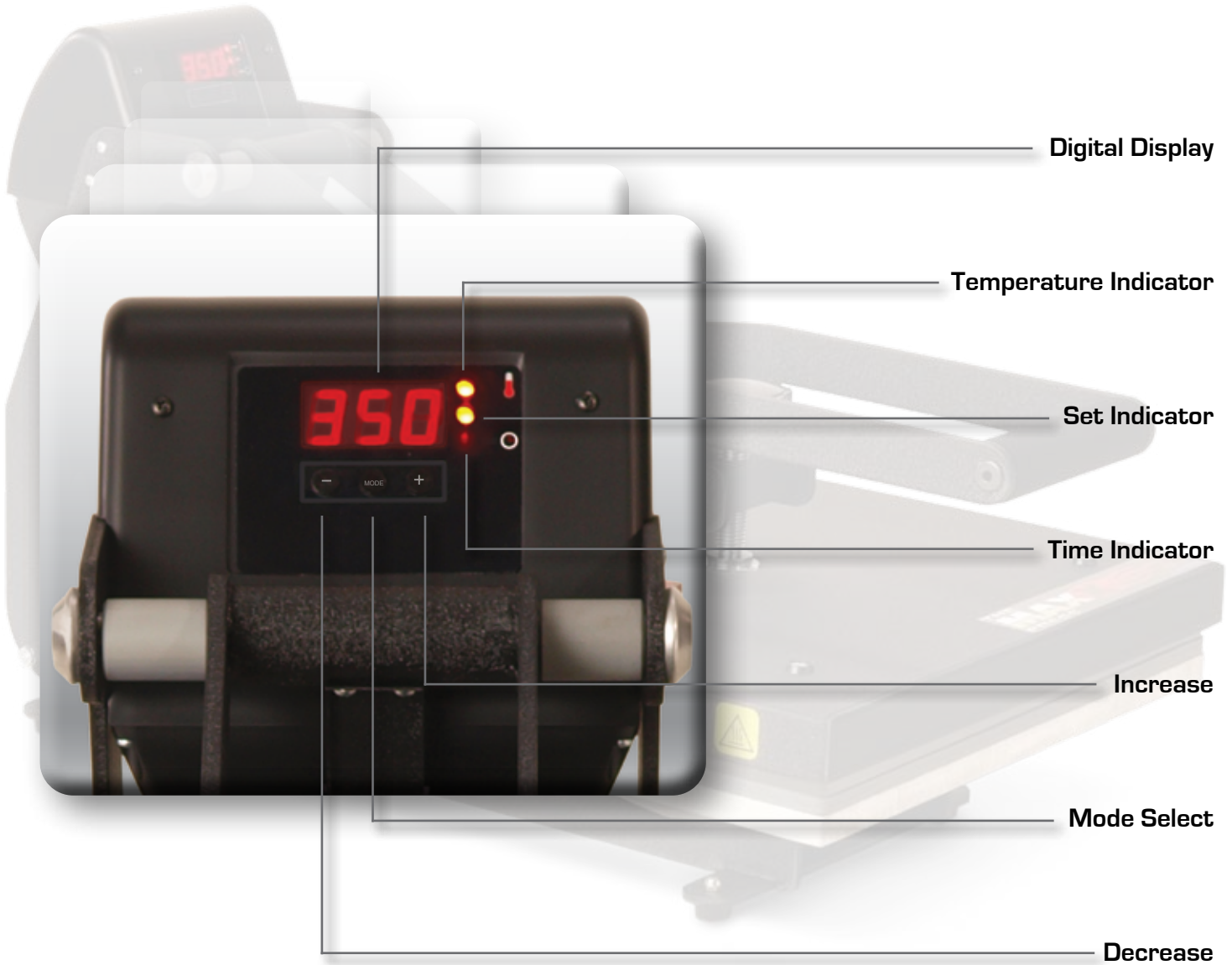

The MAXX™ Press

Operating Instructions

The MAXX™ Press DIGITAL CLAM

The MAXX™ Press Digital Clam Operating Instructions are designed with the user in mind. Carefully read and follow the step-by-step instructions for best results.



- To avoid burns, do not touch the heated platen during use.
- Keep hands clear of the upper platen of the press during platen lock down as the pressure may cause injury.
- Press should be placed on a sturdy, suitable stand at least 36"L x 24"W x 29"H.
- Work area must be kept clean, tidy and free of obstructions.
- Power supply cord must be disconnected before cleaning or servicing press.

Connecting the System

1. CONNECT THE POWER CORD

1.1 Connect the power cord into a properly grounded electrical outlet with a sufficient amperage rating.

■ **VOLTAGE:**

120 Volt - The MAXX™ Press Digital Clam requires a full 20 amp grounded circuit for 120 volt operation.
240 Volt - The MAXX™ Press Digital Clam requires a full 10 amp grounded circuit for 240 volt operation.

■ **EXTENSION CORDS:** If used, should be as short as possible and not less than 12 gauge.
Heavy duty cords are recommended.

■ **CIRCUITS:** that have less than 15 amps or that have other high demand equipment or heat presses plugged in should not be used.

NOTE: If the supply cord is damaged, it must be replaced by the manufacturer, its service agent or a similarly qualified person in order to avoid hazard. Use HSJ type, rated 250 V - 10 AMP for replacement.

CAUTION: Failure to follow these instructions will cause:

1. Erratic controller functions.

2. Inaccurate displays and slow heat-up.

3. The circuit breaker to disengage.

Turning the System On

2. SWITCH THE SYSTEM ON

- See the diagram below for switch placement.

2.1 Locate the lift handle and position the heat platen in the “UP” (load) position.



Power ON/OFF Switch



2.2 Now, locate the Power ON/OFF Switch on the side of the press, then turn the Power Switch on.

Adjusting the Temperature

3. ADJUST THE TEMPERATURE

- Locate the LED Display on the Press.
- 3.1 Press the Mode Select button located in the center of the Control Panel.
The (SET) and (TEMP) lights located next to the display will illuminate indicating you are in the adjust temperature mode.
- 3.2 Next, press the [-] button located to the left of the Mode Select button to lower the temperature setting, or press the [+] button located to the right of the Mode Select button to raise the temperature setting.
The temperature can be set from 205° F (96° C) to 430° F (220° C).
- The LED will display changes as you make them.



NOTE: The temperature indicator will only display temperatures 200°F (93°C) and up.

Adjusting the Time

4. ADJUST THE TIME

- 4.1 Once you have adjusted the temperature, press the Mode Select button again. This will advance you to the Time mode. The set and time lights will illuminate, indicating that you are in the Time mode.
- 4.2 Adjust the time in the same manner that you adjusted the temperature. Select the desired time and push the Mode Select button again to exit the time settings. All lights will be off and the press will return to the Print Mode.



Adjusting the Pressure

5. ADJUST THE PRESSURE

- The MAXX™ Press Digital Clam features a patented, Over-the-Center Pressure Adjustment located in the center of the heat platen.

5.1 Adjust the pressure by turning the knob clockwise to increase pressure and counter clockwise to decrease pressure.

Over-the-Center
Pressure Adjustment Knob



REMEMBER: To allow for the thickness of your garment when adjusting the pressure.

WARNING: Structural damage caused by excessive pressure is not covered under the limited warranty!

Printing/Pressing

6. PRESS

6.1 Once your equipment has reached the designated temperature, position the garment and application and proceed to press.

6.2 Lower and lock the heat platen into the press position. This procedure will start the automatic timing process.



6.3 The timer will automatically count down and audibly signal you to lift the heat platen into the “UP” position when the press cycle is complete.

- The time will automatically re-set and you are ready to continue with the next application.

The MAXX™ Press Replacement Parts List

Item #	Part Name	Part #	Qty.	
1	Hex Soc Button HD # 10 - 32 x 1/2"	3 - 1011 - 164	4	
2	Rubber Foot	1 - 1256	4	
3	Acorn Hex Nut	3 - 1011 - 182	4	
4 A-B	Hex Cap HD Screw - 3/8" - 16 x 3/4"	16 x 20 15 x 15	3 - 1011 - 41	2
5	Lock Spring Washer	2 - 1006 - 43	2	
6	Hex Soc Screw 1/4 - 20 x 1 1/4"	3 - 1011 - 62	4	
7 A-B	Lower Platen Spacer	16 x 20 15 x 15	1 - 1279	2
7 C	Lower Platen Spacer	11 x 15	0140	1
8	Nylon Hex Nut	2 - 1006 - 20	2	
9	Ball Stud - 10mm	1 - 1939	4	
10 A	Gas Spring	16 x 20	1 - 2243	2
10 B-C	Gas Spring	15 x 15 11 x 15	1 - 2246	2
11	Steel Spacer	1 - 2114	2	
12	Bridle Links	KIT 3 - 6906	2	
13	Nylon Washer	1 - 1048 - 3	6	
14	Threaded Pin 1/4" - 20 x 3"	1 - 2091	1	
15	PVC Spacer 1/2" I.D. x 2.48	1 - 2098	1	
16	Threaded Pin 3 5/8" x .5" Dia. 1/4" - 20	1 - 2092	1	
17 A	Lower Platen	16 x 20	2 - 1029	1
17 B	Lower Platen	15 x 15	3 - 1086	1
17 C	Lower Platen	11 x 15	3 - 1199 - 1	1
18 A	Silicone Pad Gray	16 x 20	1 - 1011	1
18 B	Silicone Pad Gray	15 x 15	1 - 1473	1
18 C	Silicone Pad Gray	11 x 15	1 - 1875	1
19 A	Heat Platen	16 x 20	2 - 1002 - 3	1
19 B	Heat Platen	15 x 15	3 - 1320	1
19 C	Heat Platen	11 x 15	3 - 1199	1
20 A	Heat Platen Cover	16 x 20	3 - 1332	1
20 B	Heat Platen Cover	15 x 15	3-1337	1
20 C	Heat Platen Cover	11 x 15	3 - 1331	1
21	Finish Washer	1 - 1063	4	
22	Cover Screw 10 - 24 x 1/2"	3 - 1011 - 217	4	
23	Adjustment Spindle	2 - 1081	1	
24	Pressure Adj. Knob	1 - 1012	1	
25	Safety Bolt " - 18 x 4 1/2"	3 - 1011 - 238	1	
26 A-B	Elbow 90 degree with tubing	16 x 20 15 x 15	1 - 1940	1
26 C	Topaz Connector with flex tubing	11 x 15	1 - 1353	1
27	Shoulder Bolt	3 - 1011 - 55	1	
28	Steel Pin 1/2" Dia. x 4.38	1 - 2093	2	
29	Soc HD Cap Screw 1/4" - 20 x 3/8"	3 - 1011 - 215	2	
30	Hex HD Nut - 1/4" - 20	2 - 1006 - 12	2	
31	Steel Pin - 1/2" Dia. x 6.45	1 - 2094	2	
32	PVC Spacer - 1/2" I.D. x 1.1	1 - 2097	4	
33	Nylon Nut	2 - 1006 - 20	1	
34	Rubber Foot	1 - 1256	1	
35 A-B-C	Adjustment Arm Assembly	16 x 20 15 x 15 11 x 15	KIT 3 - 6903	1
36	JCN Nut	2 - 1006 - 2	2	
37	Foam Grip	1-1540	1	
38	PVC Spacer 1/2" I.D. x 5"	1 - 2096	1	
39	All Thread Pin - 1/4" - 20 x 4 3/4"	1 - 1042 - 1	1	
40	Lift Links	KIT 3 - 6905	2	
41	Hucap 1/2"	1 - 1107 - 1	8	
42	Magnet	1 - 1219	1	
43	Magnet Bracket	1 - 2085	1	
44 A-B-C	Handle Assembly	16 x 20 15 x 15 11 x 15	KIT 3 - 6904	1
45	Phillips Pan HD Screw - #6-32 x 1/2"	3 - 1011 - 152	4	
46	Housing	4 - 1172	1	
47 A-B-C	Base Assembly	16 x 20 15 x 15 11 x 15	KIT 3 - 6901	1
48	Proximity Switch	1 - 1211	1	
49	Terminal Block	1 - 1290	1	
50	Triac	1 - 1059	1	
51	Controller Bracket	2 - 1661	1	
52	SSTT Control Board	1 - 2017	1	
53	On/Off Switch	1 - 2087	1	
54	Circuit Breaker	1 - 1331	1	
55	Display Overlay	1 - 2018	1	
56	Probe	1 - 1272 - 1	1	

The MAXX™ Press Parts Location Guide

The MAXX™ Press Digital Clam is available in three sizes: **16 x 20, 15 x 15, 11 x 15**

When ordering replacement parts, refer to the following color codes

For a 16"x20" press - use color code **A**

For a 15"x15" press - use color code **B**

For a 11"x15" press - use color code **C**

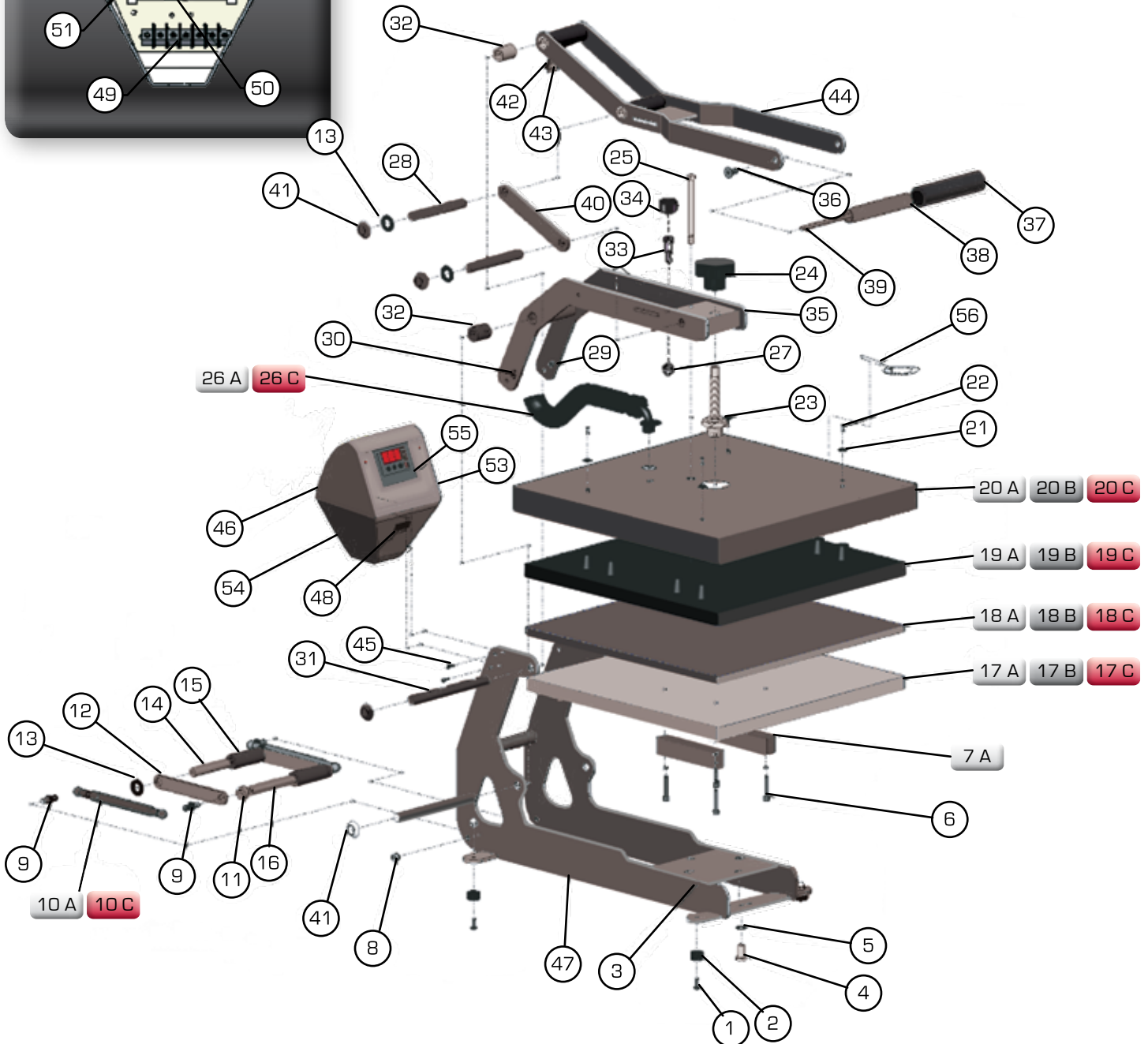
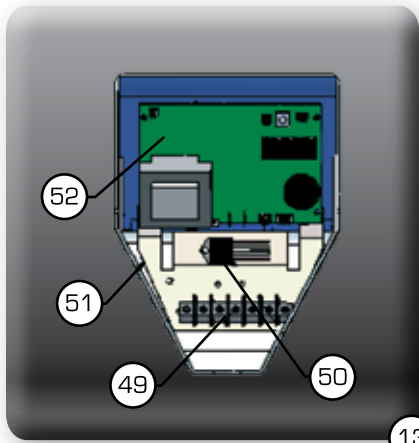

The MAXX™ Press

Electrical Schematic

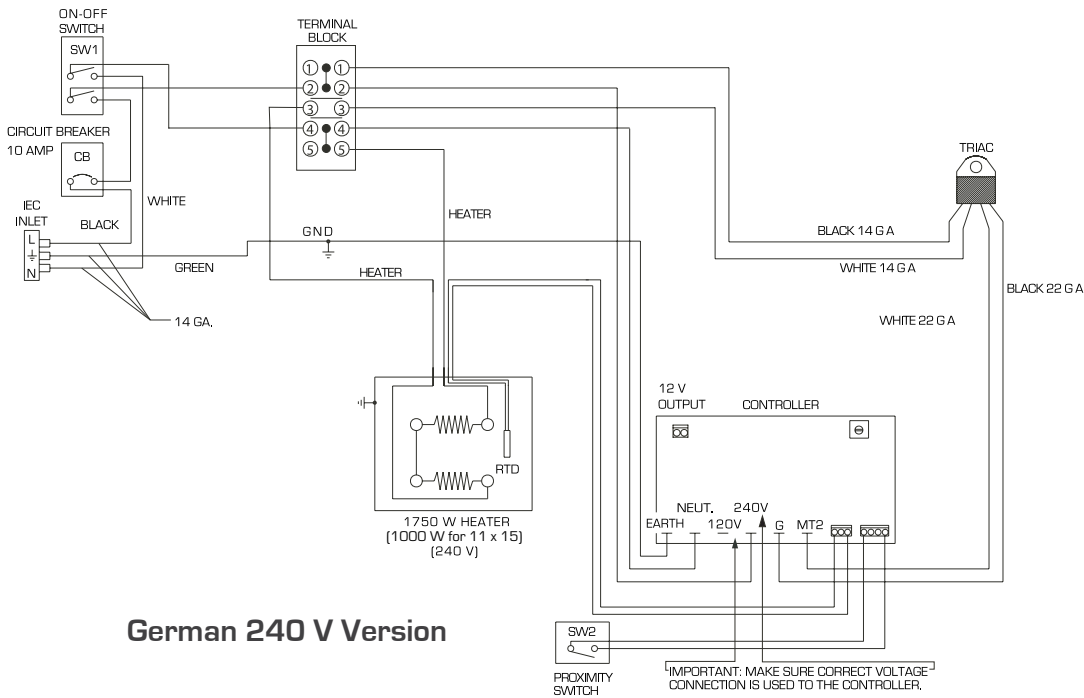
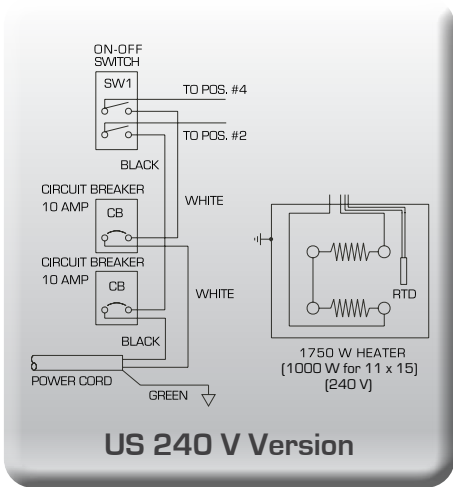
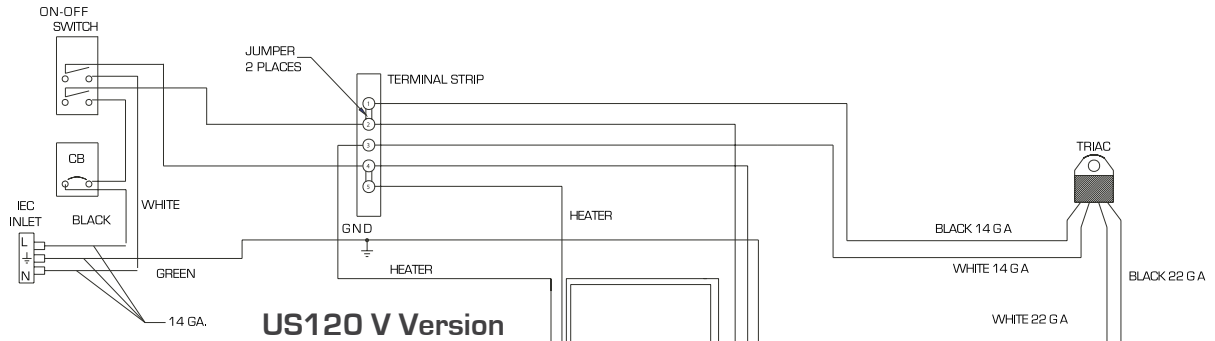

Contact Us

STAHL'S International
20600 Stephens Street
St. Clair Shores, MI 48080
U.S.A.



phone

(001) 586 . 772 . 5551

fax

(001) 586 . 772 . 6237

email

info@stahlsinternational.com

web

StahlsInternational.com



This document includes multiple trademarks and describes equipment covered by many patents that are owned by GroupeSTAHL and/or its subsidiaries. GroupeSTAHL enforces its rights to protect these intellectual properties. © 2011

®

STAHLS' INTERNATIONAL

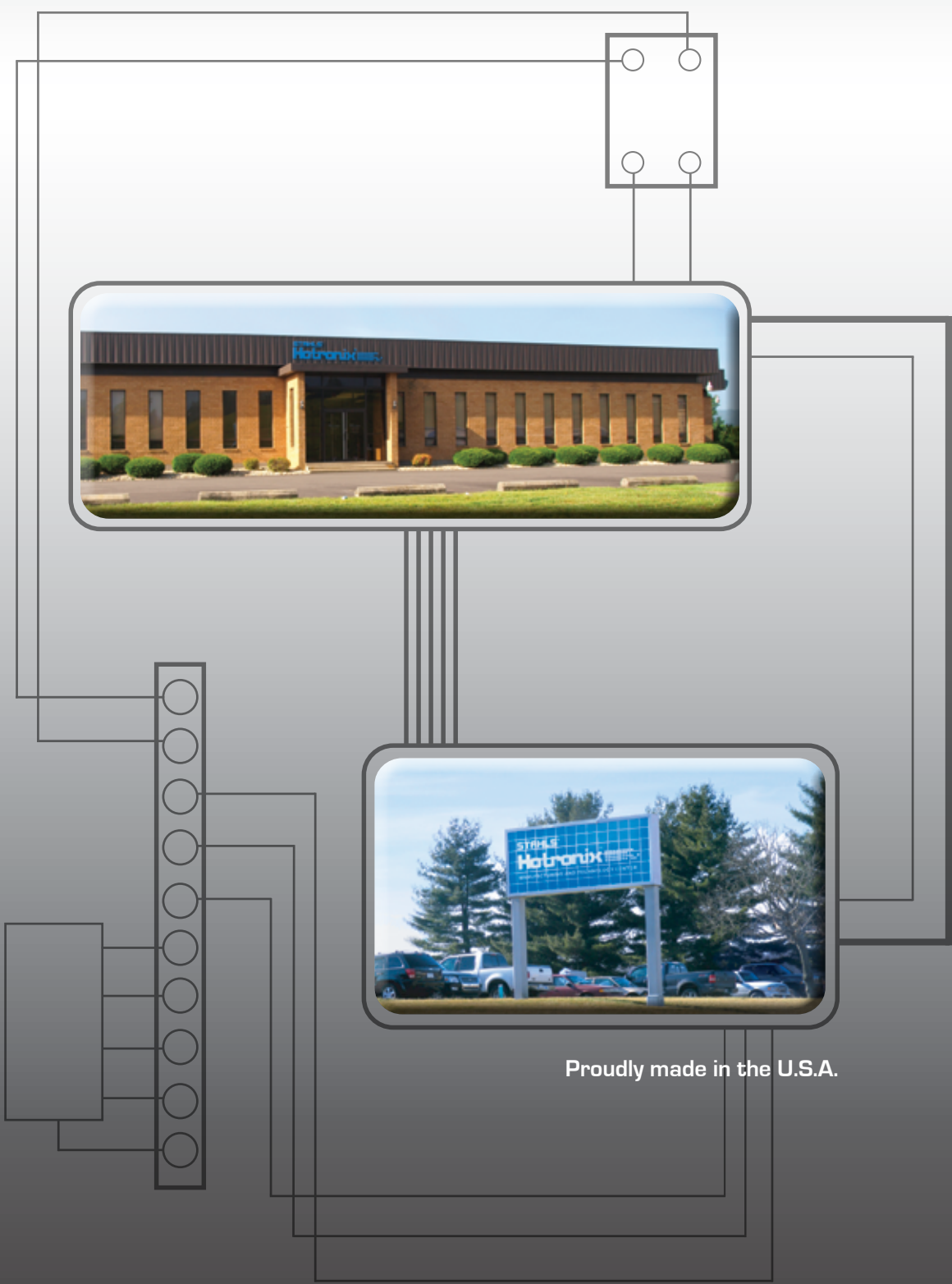

Proudly made in the U.S.A.

20600 Stephens Street St. Clair Shores, MI 48080, U.S.A.
t (001) 586 . 772 . 5551 f (001) 586 . 772 . 6237
e info@stahlsinternational.com w StahlsInternational.com

